

TUMÄ

Installation and Operating Instructions **ECO DC Brushless Bathroom Ventilation Fan/Filter**

GENERAL SAFETY INFORMATION

1. Available in either 100V or 240V.
2. Always disconnect the power source before working on or near the ventilating fan, motor or junction box.
3. Follow all local electrical and safety codes.
4. Protect the power cord from sharp edges, oil, grease, hot surfaces, chemicals or other objects.
5. Provide suction parts with proper ventilation.
6. These ventilating fans are intended for residential usage only.
7. The fan is to be installed so that the blades are more than 2.5m above the floor.
8. Do not install the unit where ducts are configured as shown in Fig. A.

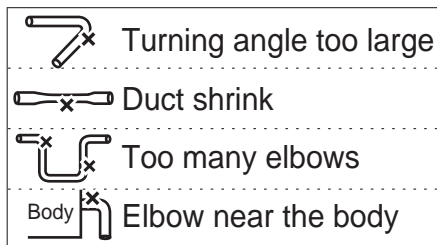

Fig. A

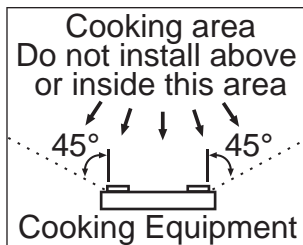

Fig. B

CAUTION

1. For general ventilating use only. Do not use to exhaust hazardous or explosive materials and vapors.
2. Not for use in cooking areas. (Fig. B)
3. Do not dispose of electrical appliances as unsorted municipal waste, use separate collection facilities.
4. Contact your local government for information regarding the collection systems available.
5. If electrical appliances are disposed of in landfills or dumps, hazardous substances can leak into the groundwater and get into the food chain, damaging your health and well-being.
6. When replacing old appliances with new ones, the retailer is legally obligated to take back your old appliance for disposal at least for free of charge.
7. Indoor distribution terminal wire should be used at least 0.75 mm² diameter wire.
8. Connect wiring. The installation must be provided with a double pole isolator switch having a contact separation of not less than 3 mm.



9. After the unit is installed, only the side of the fan that faces the user is IPX4/IPX5 capable. Note the unit top (ceiling side) is not waterproof. The structure is an IPX0 structure.
10. The wall or ceiling area around the unit shall NOT have any openings where water can access the ceiling side of the unit after the completed installation.
11. DO NOT install the unit on ceiling/wall area, where water can access the ceiling side of the unit.
12. Water pipes within the building structure shall be out of reach of the unit where water can access to ceiling side of the unit in case of water pipe rupture.
13. (for EU region) This appliance can be used by children aged from 8 years and above and persons with reduced physical, sensory or mental capabilities or lack of experience and knowledge if they have been given supervision or instruction concerning use of the appliance in a safe way and understand the hazards involved.
14. (for EU region) Children shall not play with the appliance.
15. (for EU region) Cleaning and user maintenance shall not be made by children without supervision.
16. (for other than EU region) The appliance is not to be used by persons (including children) with reduced physical, sensory or mental capabilities, or lack of experience and knowledge, unless they have been given supervision or instruction.
17. (for other than EU region) Children being supervised not to play with the appliance.

1. INSTALLATIONS

- 1-1. Pull existing ductwork into duct connector tape all ductwork connections to make them secure and airtight.

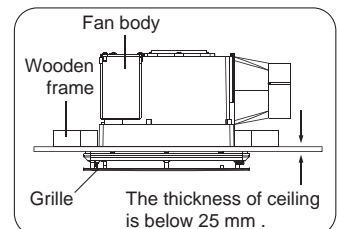
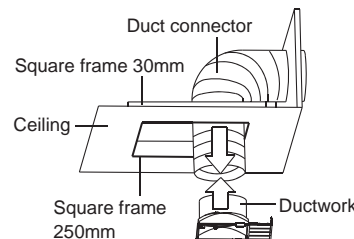

- 1-2. Insert tab slot in wooden frame and secure using self-tapping screw.

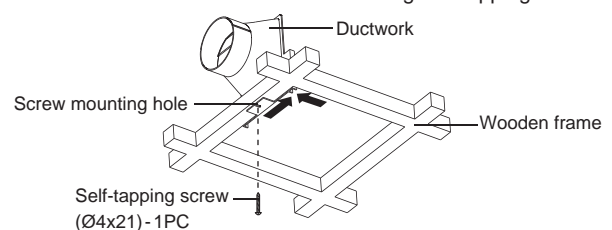

1-3. Please follow the below description to connect power cord.

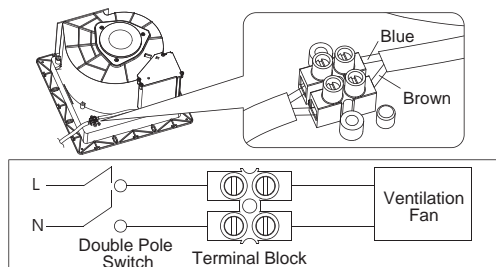

1-4. Insert the body in duct connector make sure fan body is level and perpendicular to the duct connector.

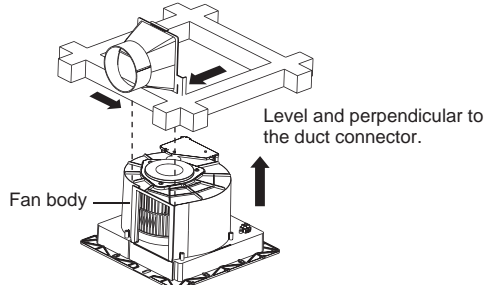

1-5. Using 4 self-tapping screws (Ø4x21).

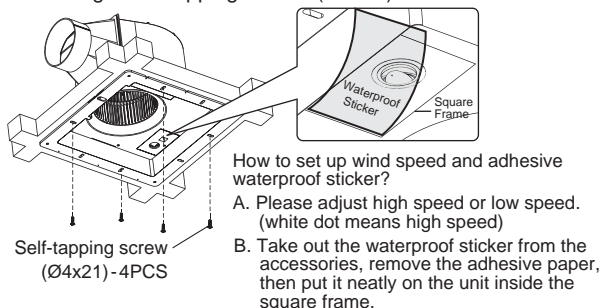

1-6. Follow steps 1 to 5 of the installation to complete the installation work.

1-7. Grille attachment.

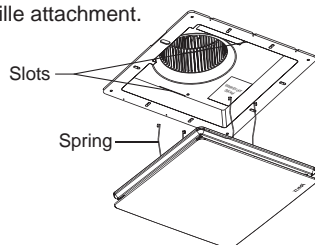

2. DUCT CONNECTION

- 2-1. Insert the duct into the duct connector and tape all ductwork connections to make them secure and airtight.
- 2-2. Install the duct with a gradient 1°~2° to the outside.

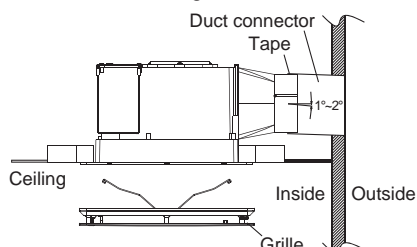

3. TEST RUN & GRILLE ATTACHMENT

- 3-1. When the power on, check for abnormal vibration or sound.
- 3-2. Insert the mounting springs into the slots and mount the grille to the fan unit.

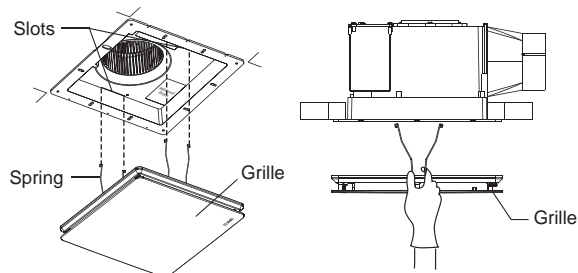

4. MAINTENANCE

WARNING:

Disconnect power source before working on unit.
Routine maintenance must be done every year.

CAUTION:

- 4-1. Never use gasoline, benzene, thinner or any other such chemicals for cleaning the ventilating fan.
- 4-2. Do not allow water to enter motor.

CLEANING

A. Filter Cleaning

A-1 Pull the panel lightly from the circle mark side and open the cover, twist the filter handle slightly to remove the filter.

A-2 Clean the filter with water, leave it to dry, then put it back on.

B. Overall Cleaning

B-1 Pull down the spring to remove grille.

B-2 Clean grille. (Use non-abrasive kitchen detergent , wipe dry with new cloth.)

B-3 Use a cloth dampened with non-abrasive kitchen detergent, remove dust and dirt from ventilating fan. Wipe dry with new cloth.

B-4 Replace grille.

SPECIFICATIONS

Model No.	Voltage (V)	Frequency (Hz)	Speed	Power (W)	Air Flow (m³/h)	Weight (KG)
BVN25A001	100-240	50-60	High Low	19 8	254 180	2.4

Note : Design and specifications subject to change without notice.

DIMENSIONS

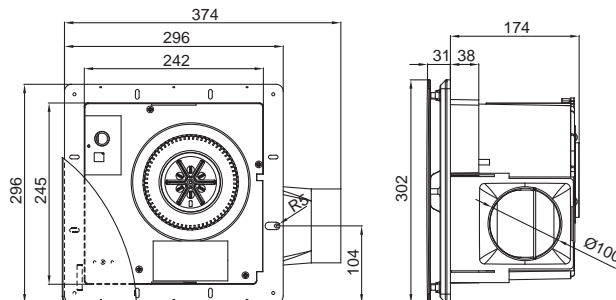

Unit : mm Accessory : Self-tapping screw(Ø4x21)-5PCS

Instructions Download : www.tuma.com.my